

WIDESPAN GROW

INSTALLATION



If you require assistance, or if there are parts missing, please contact Spacesaver

Toll-Free: 877.274.3043 | Fax: 877.274.3044 | info@spacesaver.com

visit our website: www.spacesaver.com | www.military.spacesaver.com



TABLE OF CONTENTS

INTRODUCTION	3
ANCHOR FEET ASSEMBLY	4
BEAM INSTALLATION	5
BEAM SPACING	6
REQUIRED ANCHORING	7
OPTIONAL STATIC TIES	8
SLOPED FRONT TO BACK BRACKETS	9-12
FRONT TO BACK SUPPORTS	13
TRAY INSTALLATION	14
DRAINS	15
OPTIONAL TRAY LINERS	16
HANGING LIGHTS FROM FORNT TO BACK SUPPORTS	17
GAVITA 1700e LED LIGHT MOUNTING	18
GAVITA INSTALLATION REFERENCE GUIDE	19-22

INTRODUCTION

WIDESPAN GROW is racking designed to optimize agricultural requirements for lighting, irrigation, ventilation and drainage.

Spacesaver Widespan GROW shelving and trays may be cleaned with mild soap and water and wiped dry with a soft lint free cloth.

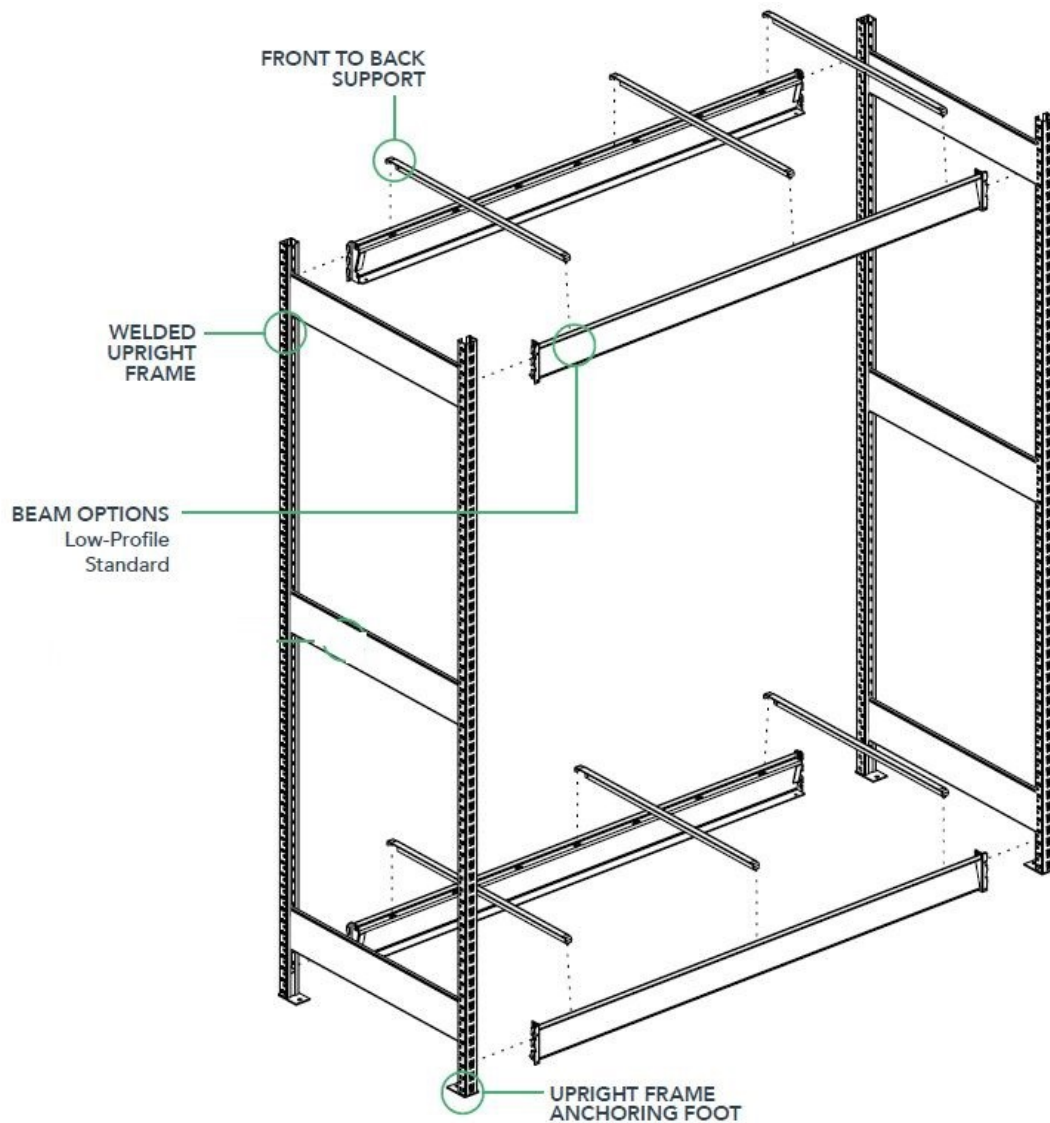

ANCHOR FEET ASSEMBLY

DETAIL OF ANCHOR FOOT

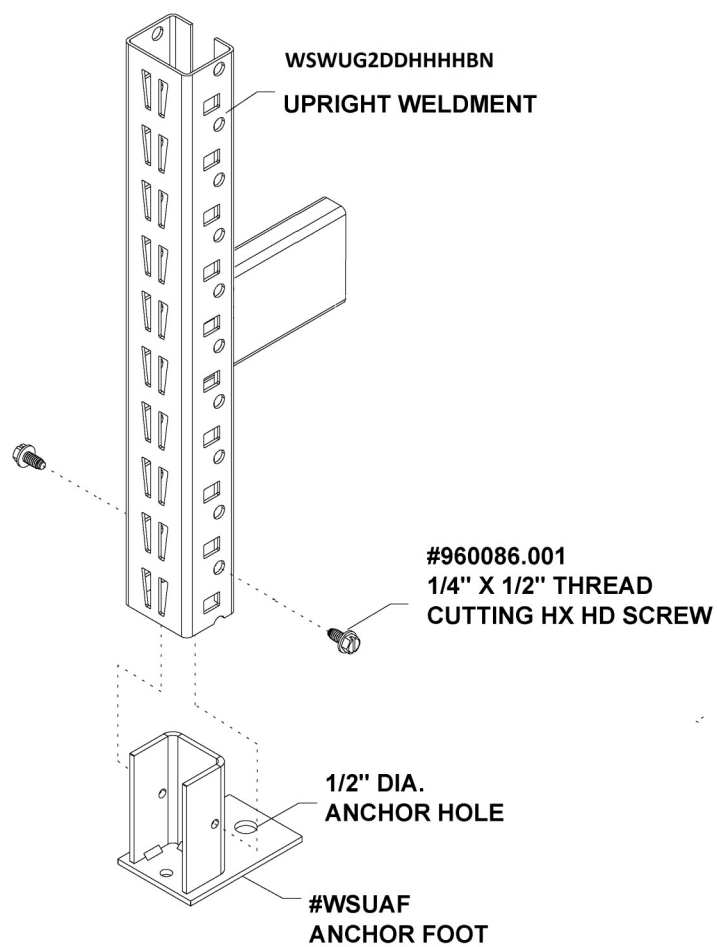

BEAM INSTALLATION

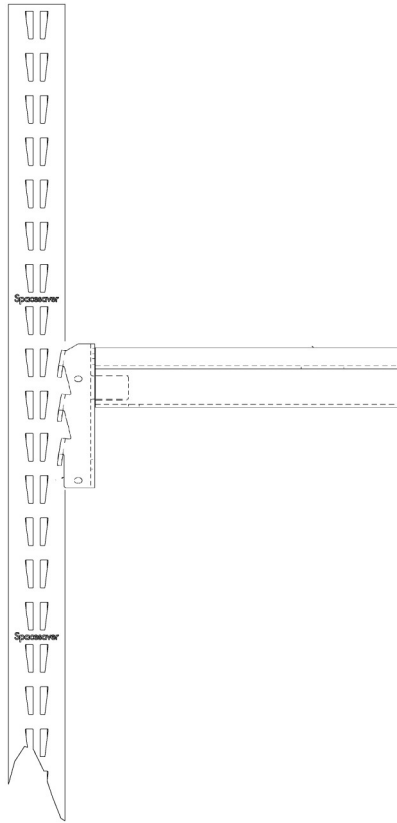

Attach beams to uprights at desired location.

Hook three tabs of beam into the slots on the post.

Bend safety tab on beam to lock into place.

If using Spacesaver GROW Trays, or Hawthorne MRT Trays the rear beam (away from drain) will be installed one notch (1.5") higher than the front beam to facilitate drainage from rear to front of the tray.

Beams for Hawthorne OD Trays will be installed level.

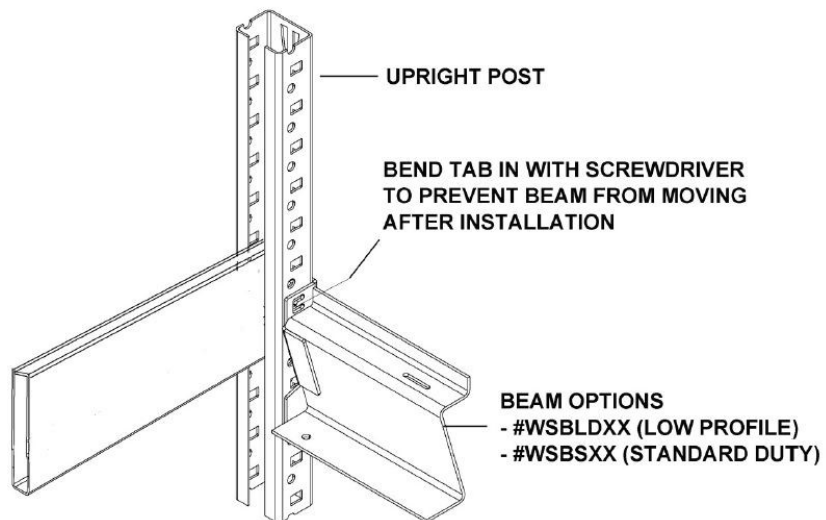

DETAIL SHOWING BEAM LOCK TAB

NOTE: BEAMS ARE ADJUSTABLE ON 1-1/2" CENTERS.

BEAM SPACING

DETAIL SHOWING TYPICAL CLEAR OPENINGS FOR STANDARD AND LOW PROFILE BEAMS

DETAIL SHOWING TYPICAL CLEAR OPENINGS

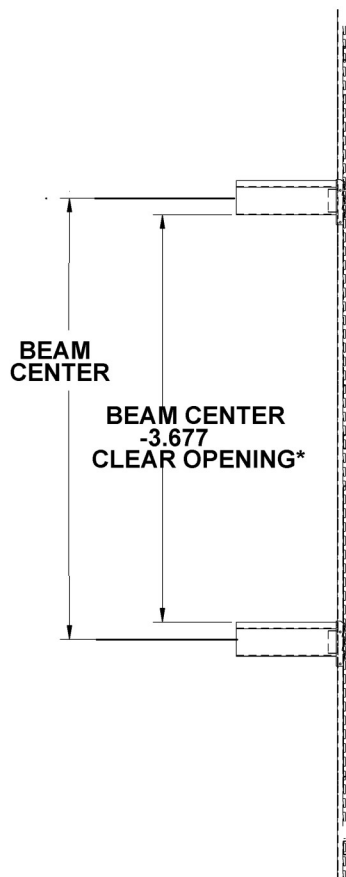
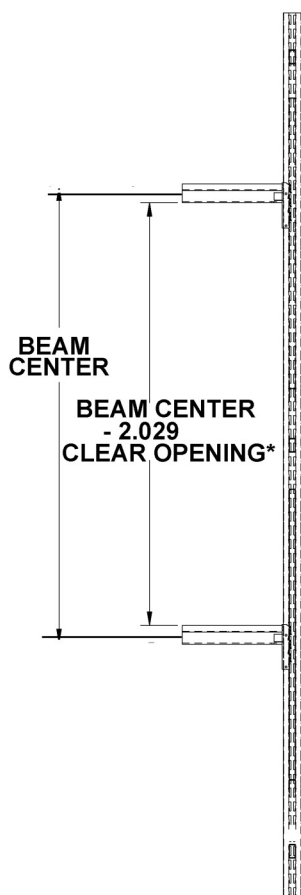

⚠ CAUTION Do not exceed 48" between Beams or upright load capacity will be reduced

Anchoring

⚠ CAUTION

All Spacesaver shelving must be anchored to the floor, carriage or a structurally sound wall or ceiling. Anchor type and size will be determined by building materials, local code or other requirements.

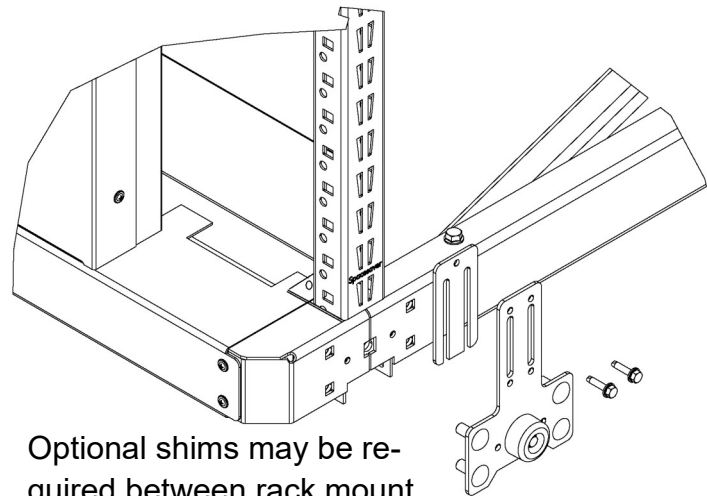
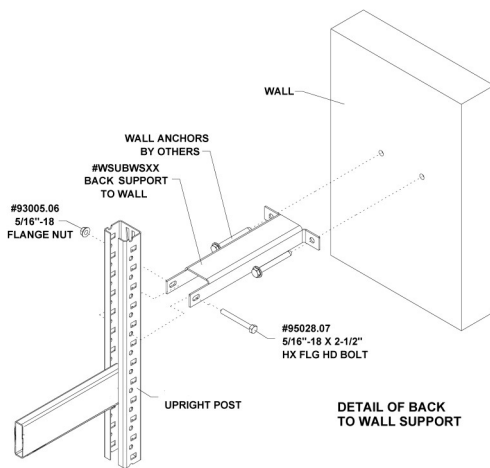

Optional shims may be required between rack mount bracket and the Widespan GROW upright posts. Review the ActivRAC3 planning guide for more information.

RAC7SHIM available in packs of 25 pieces.

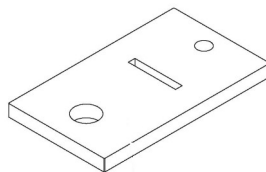
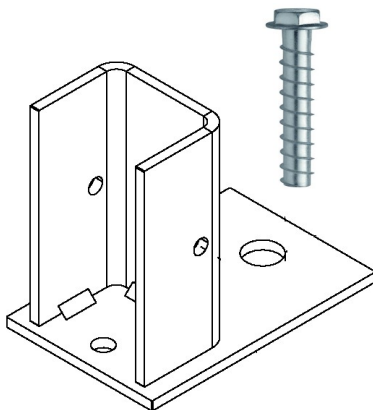

Optional leveling shims may be required under the Widespan GROW uprights before anchoring

WSUAFSHIM—Available in packs of 25 pieces.

BACK TO BACK TIES FOR STATIC APPLICATION

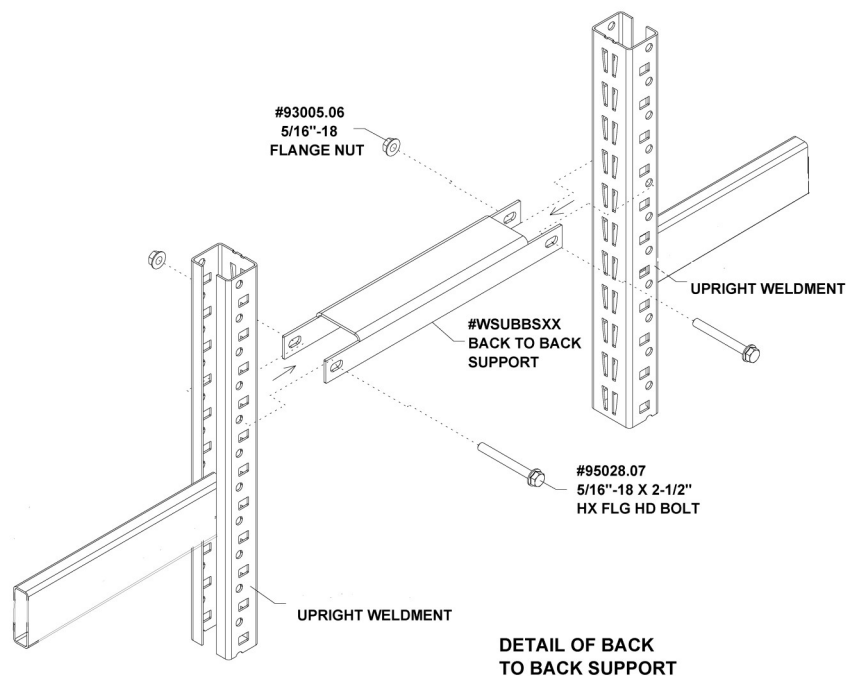
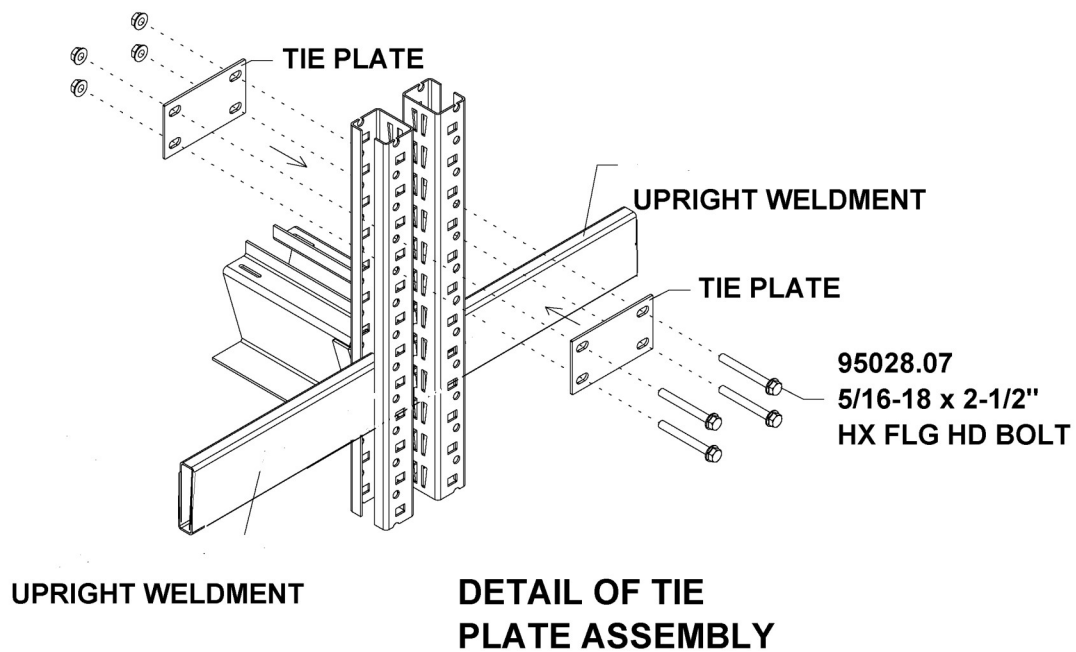

SLOPED BEAM BRACKET FOR SPACESAVER TRAYS

When installing Spacesaver GROW Trays, the tray will slope back to front and side to side.

The rear beam must be installed 1.5" higher than the front beam.

Determine which way the tray should slope: left or right.

Do not use these sloped brackets for Hawthorne trays.

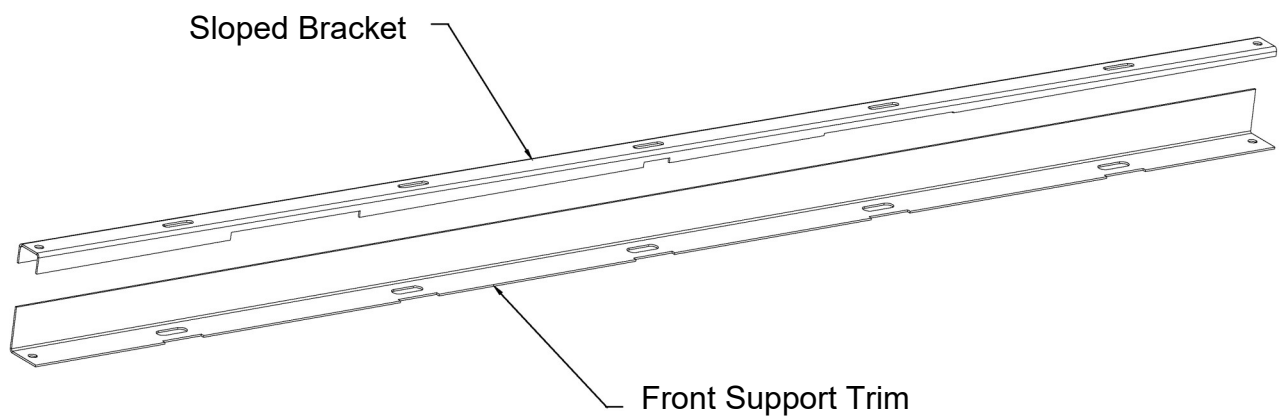

SLOPED BEAM BRACKET

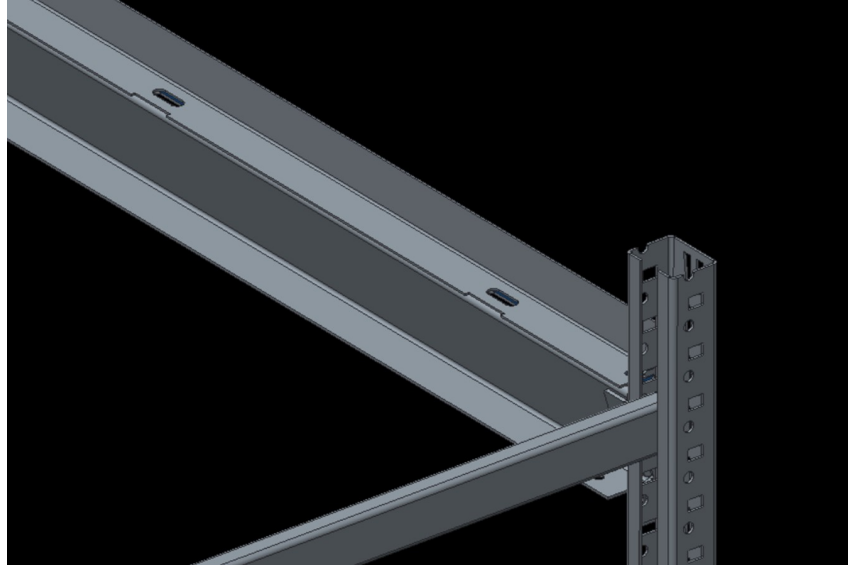

Before installing front to back supports, place front support trim piece onto flange of front beam.

On 96" beams, place only center front to back support. This will lock into the rear beam and into the trim piece and front beam.

Do not install any front to back supports at this time on 48" beams.

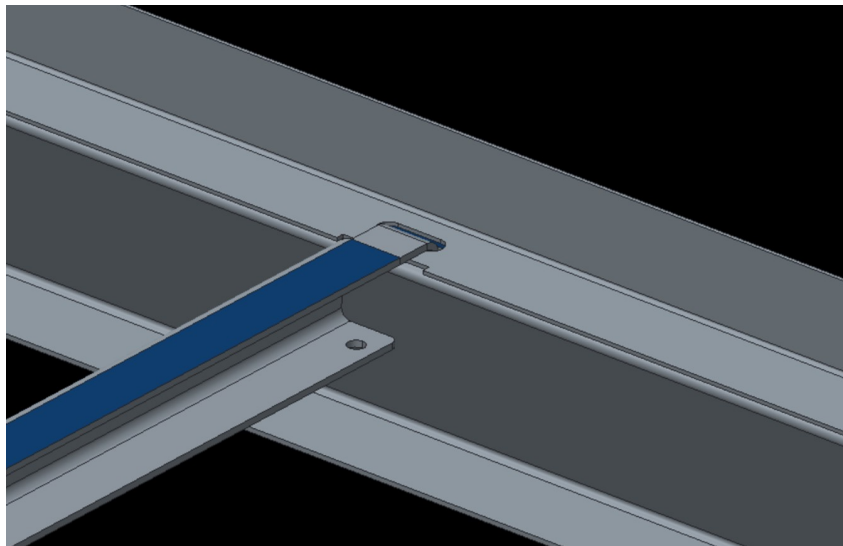

SLOPED BEAM BRACKET

Place sloped bracket into location over the trim piece and center front to back support (96" beams only)

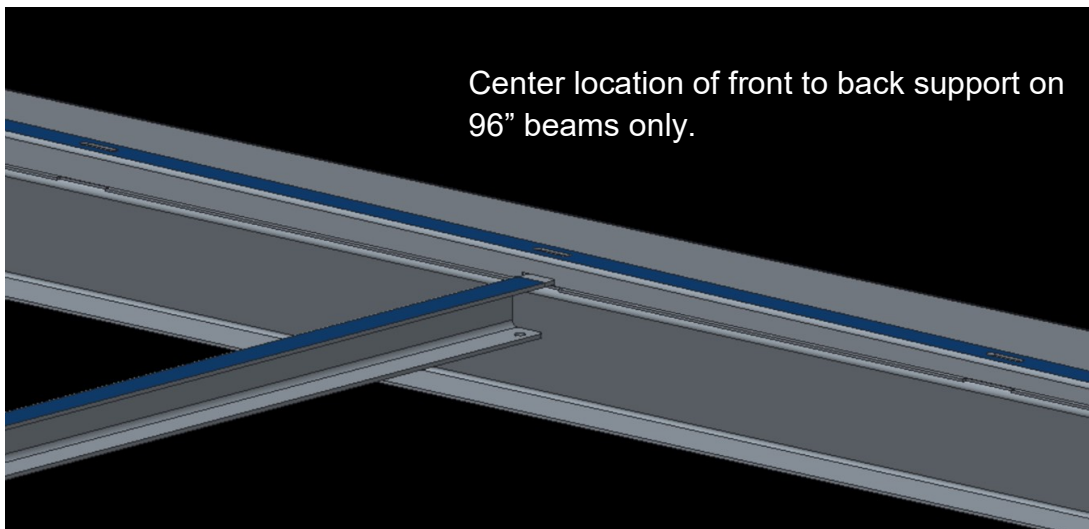
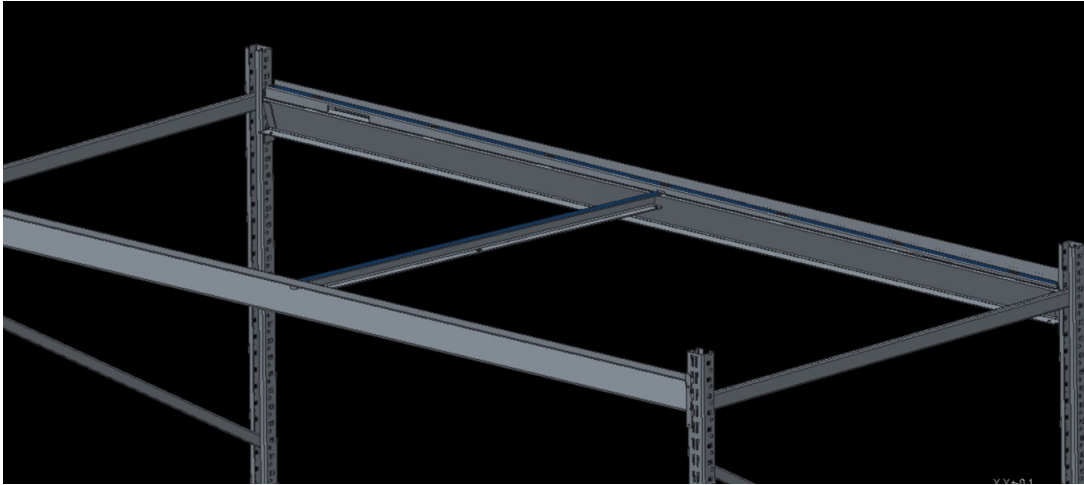

SLOPED BEAM BRACKET

Install remaining front to back supports.

The supports will engage in the back beam and engage into the sloped bracket in the front.

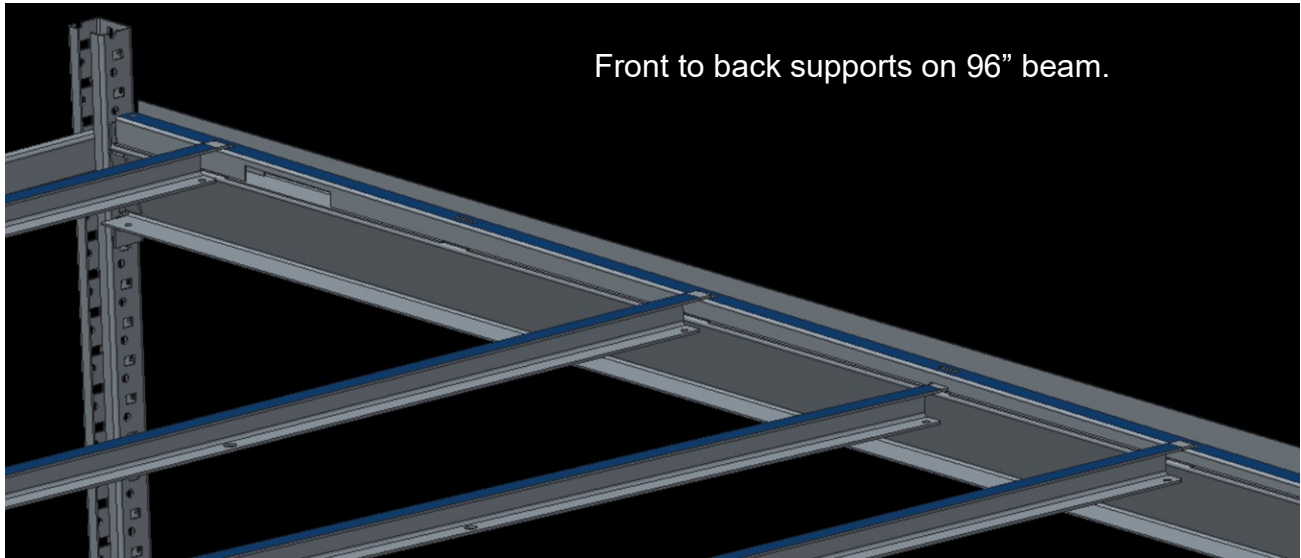

FRONT TO BACK BEAM SUPPORT

Front to back supports (WSGFBxx) must be installed to properly distribute load.
 When installing trays, refer to the illustrations below for proper placement of supports.

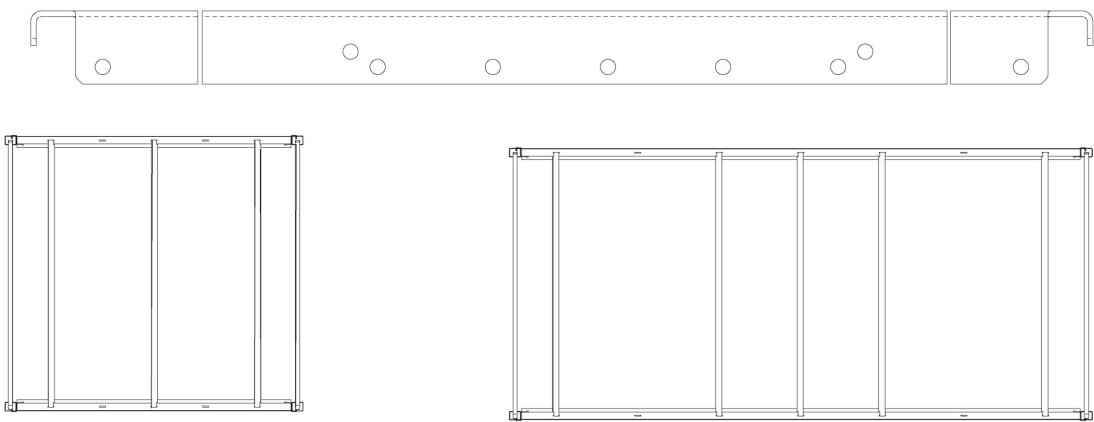

Spacesaver GROW Tray and Hawthorne Mobile Rack Tray front to back support placement

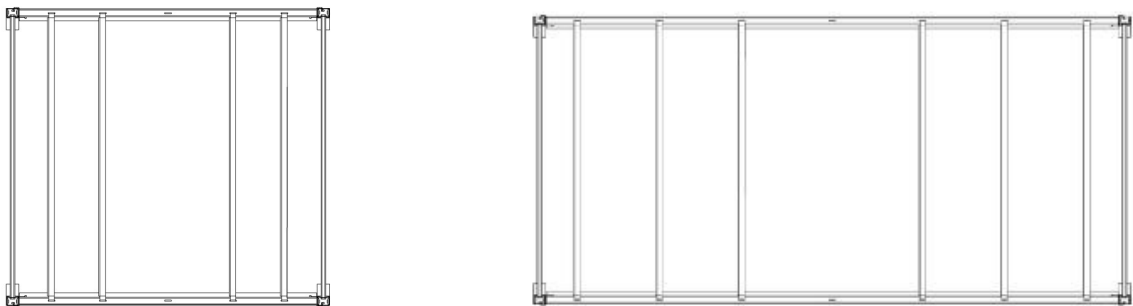

OD tray Front to Back support placement

Beam Length	Spacesaver Grow Tray	Hawthorne Mobile Rack Trays Ordered separately	Hawthorne OD Tray Ordered separately	Particle Board Deck Even space	All Other Deck Even space
48" to 59"	48" - 3	48" - 3	48" - 4	2	1
60" to 83"	NA	NA	72" - 4	3	2
84" to 96"	96" - 5	96" - 5	96 - 6	4	2

INSTALL TRAYS

Set your trays onto the beams from the front. If you are using any trays not supplied by Spacesaver, be certain the trays are properly supported.

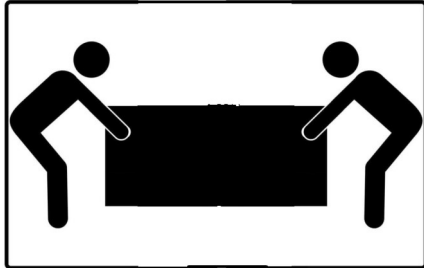

⚠ CAUTION

Always team lift trays vertically to prevent injury or damage

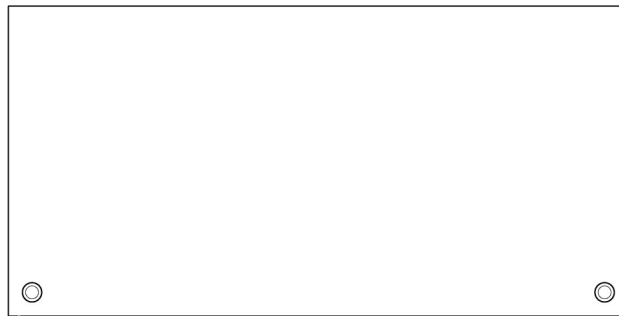

Spacesaver GROW Tray

WSGTDxxxx (width, width, depth, depth)

MOBILE RACK TRAYS



Hawthorne MRT (Mobile Rack Tray)



Hawthorne OD Tray (Outside Dimension Tray)

Drains

This drain information is referencing Spacesaver Grow Trays.

If using Hawthorne trays, refer to their documentation on proper drainage.

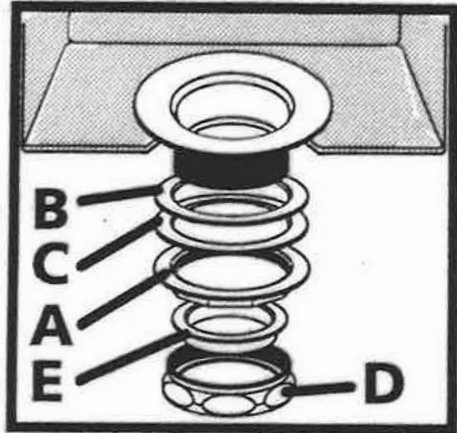

1. Apply a small amount of plumbers putty evenly around the top of the hole in the tray.
2. Insert basket strainer into tray opening.
3. Slip rubber (B) and fiber (C) washer to bottom of tray.
4. Thread locknut (A) to washers and tighten.
5. Put washer (E) and slip nut (D) onto tailpipe of drain.
6. Remove all excess putty from around drain basket.



Optional Drop in tray liners

Steel Drop ins for Spacesaver Grow Trays

Press 4 rubber feet into each bottom corner of insert.

Line trays with inserts

GRWTDS1248 for 48" deep GROW trays

GRWTDS1236 for 36" deep GROW trays

4 each per 48" tray

8 each per 96" tray

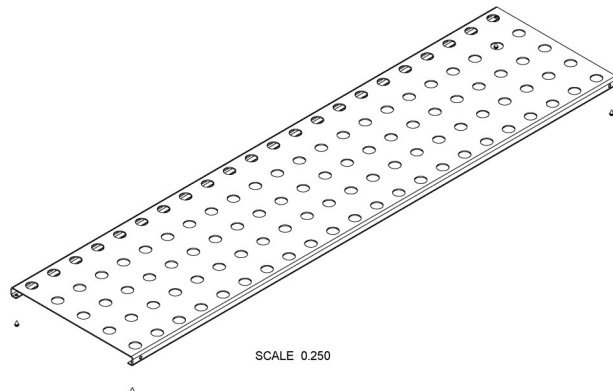

LIGHT MOUNTING TO FRONT TO BACK SUPPORTS

Typical light hang wire locations on Front to Back Supports with offset beams (GROW trays and MRT)

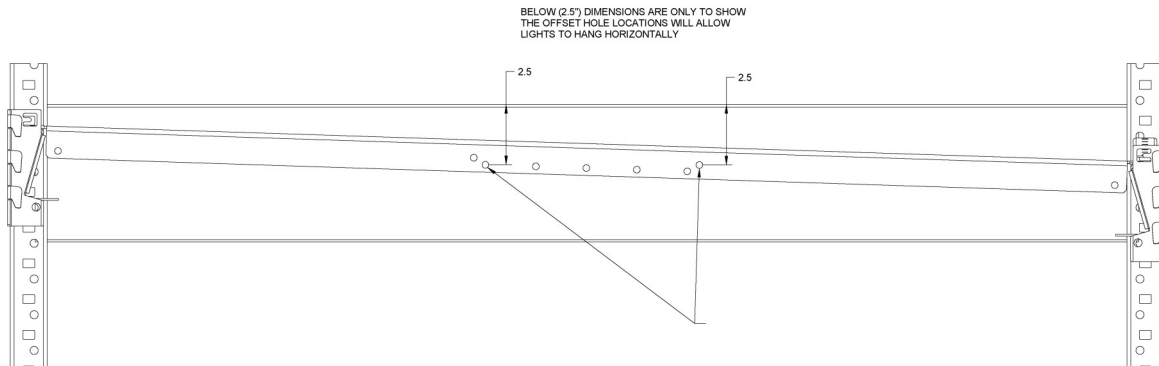

Light hanging holes when using level beams (OD trays)

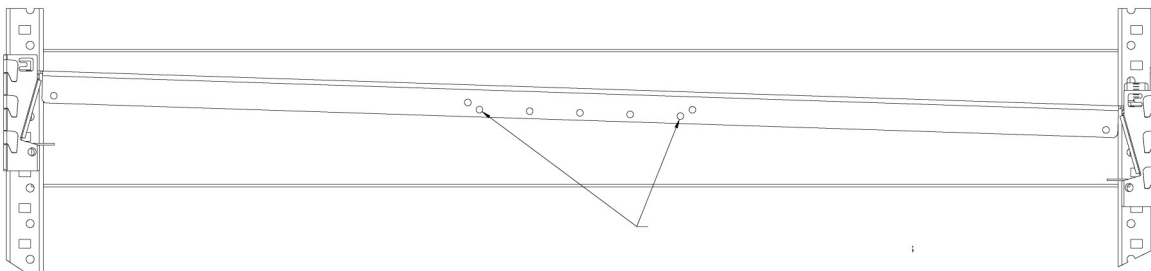

Choose correct location to place hang wires based on tray style. Using the proper location will keep lights parallel with grow surface.

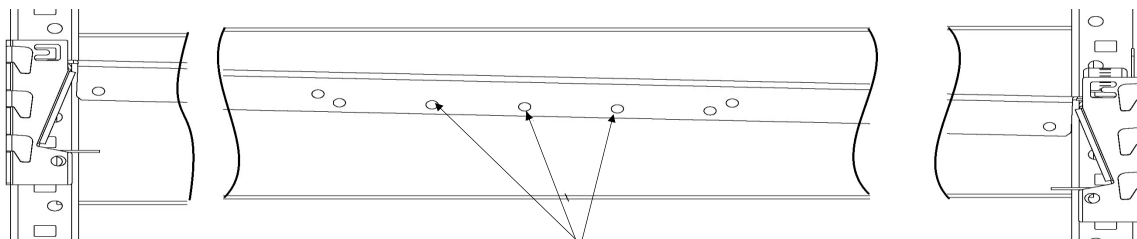

Additional holes have been added to the front to back supports to facilitate alternate light or HVAC support

GAVITA 1700e LED LIGHT MOUNTING

⚠ CAUTION

Mounting and installing LED fixtures may only be executed by certified service personnel in accordance with applicable local laws and regulations.



Follow all Manufactures instructions for installation and maintenance.

Recommended parts
for each level of lighting with Spacesaver Widespan GROW.

Hawthorne EL controllers can control up to 1,000 light fixtures.

Quantity re- quired for 96" trays	Quantity re- quired for 48" trays	Part	Description
2	1	LED Lights	Gavita 1700LED
2	1	Power Cord	Weiland Connection
2	1	Adapter	LED Adapter

Hanging parts recommended, but not included

14	8	Snap Hooks	
8	4	Hang Wires	

A good source for hang Wires is Hang Ups Unlimited, their part number DCO2L-6

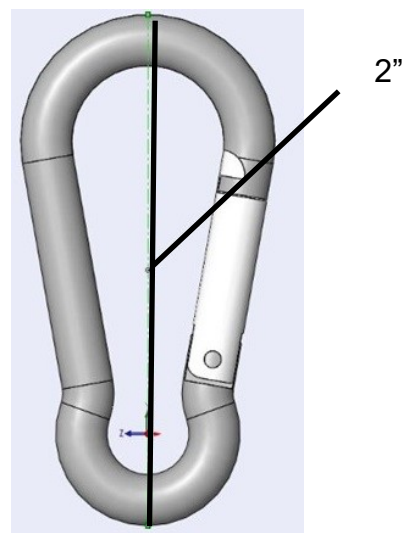
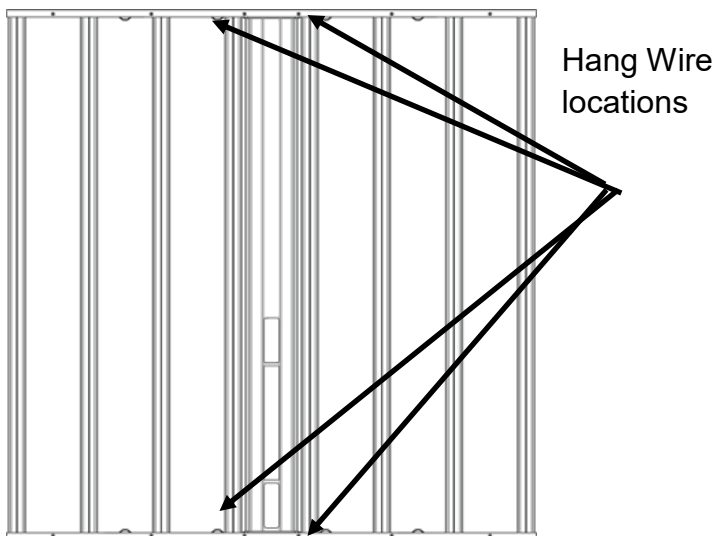

The following pages are a reference guide only and may not meet local electrical code.

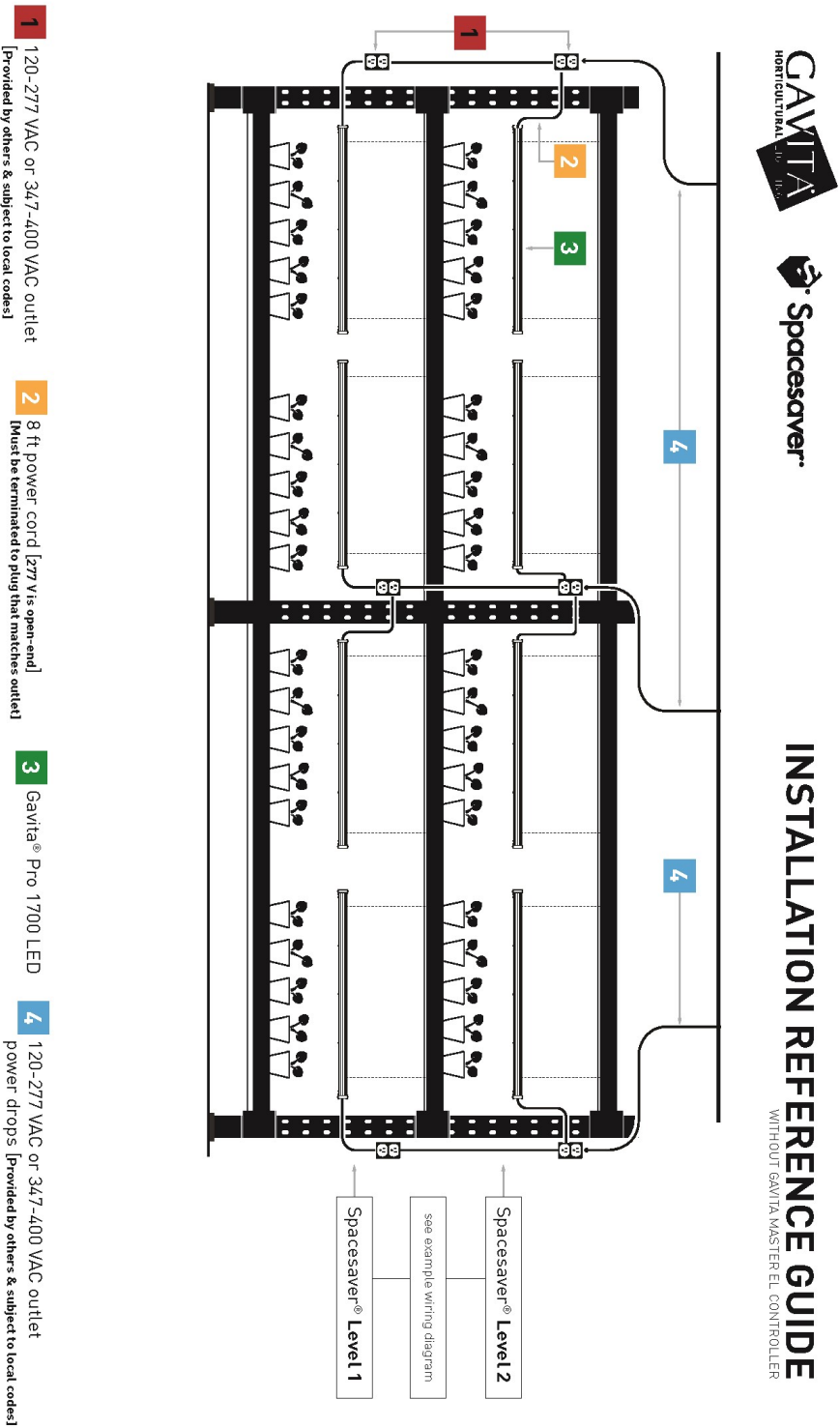

GAVITA LIGHTING

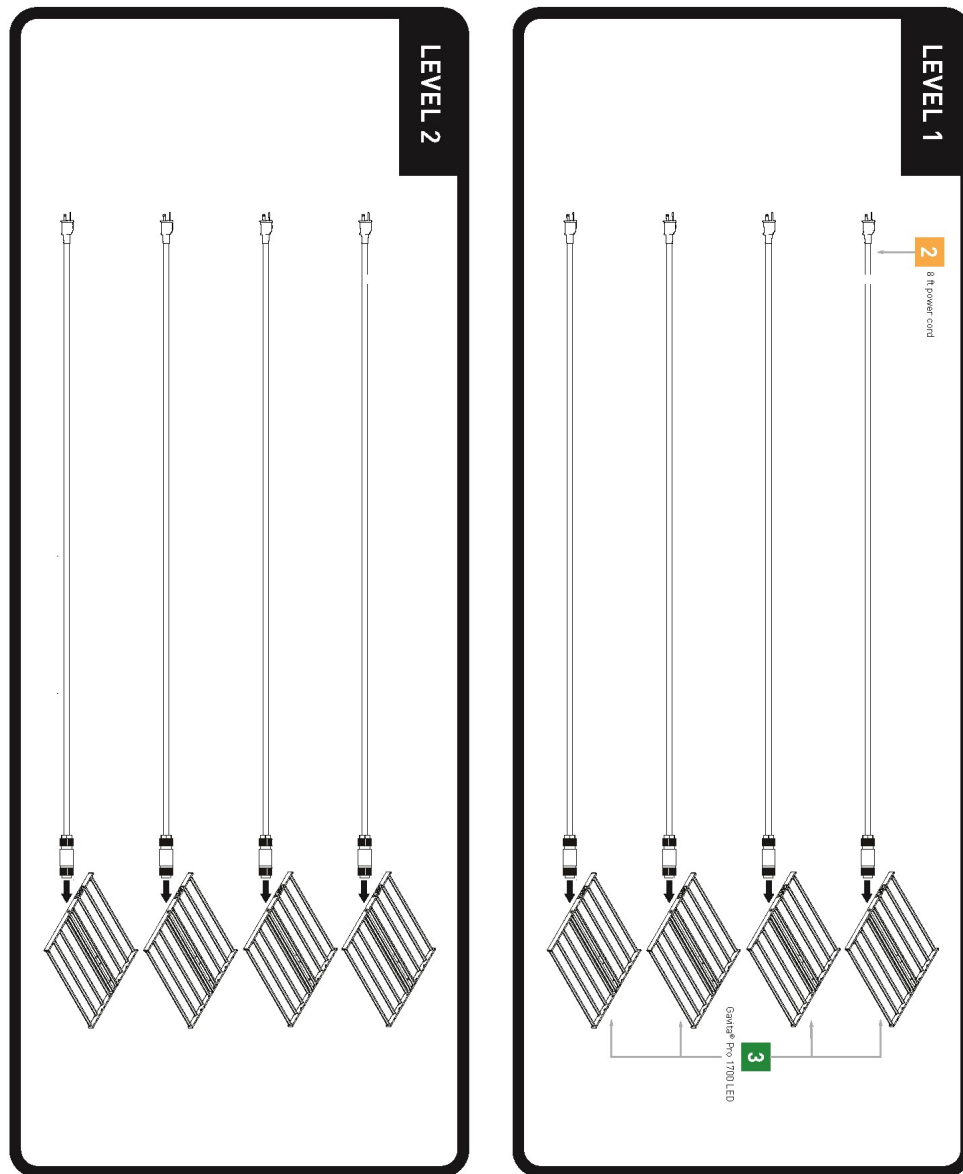



INSTALLATION REFERENCE GUIDE

WITH GAVITA MASTER EL CONTROLLER

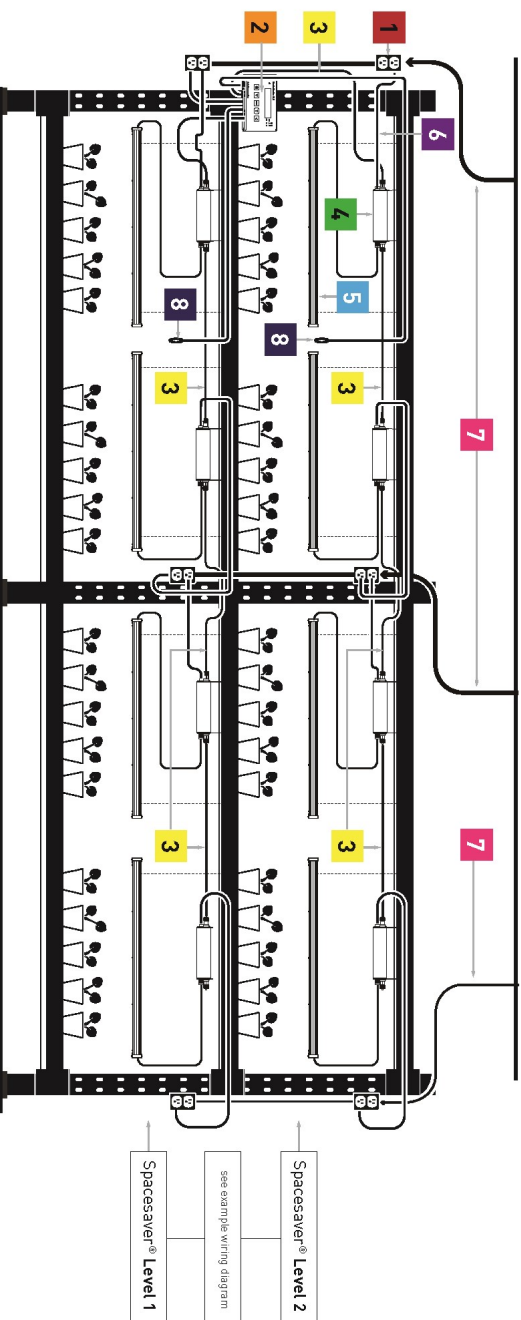

1 120-277 VAC or 347 VAC outlet
[Provided by others & subject to local codes]

4 Gavita® E-Series LED Adapter 120-277 V
or Gavita® E-Series LED Adapter 347 V

7 120-277 VAC or 347 VAC outlet power drops
[Provided by others & subject to local codes]

2 EL 1 or EL 2 Gavita® Master Controller
[Requires 120 V power source]

5 Gavita® Pro 1700 LED

8 Gavita® EL Controller Temperature Probe

3 Gavita® LED Adapter Interconnect Cables
[RJ45 / RJ45 Cable runs from the controller to the 1st adapter]
[RJ45 / RJ45 Cable runs from adapter to adapter]

6 8 ft power cord [277 v is open-end]
[Must be terminated to plug that matches outlet]

GAVITA LIGHTING

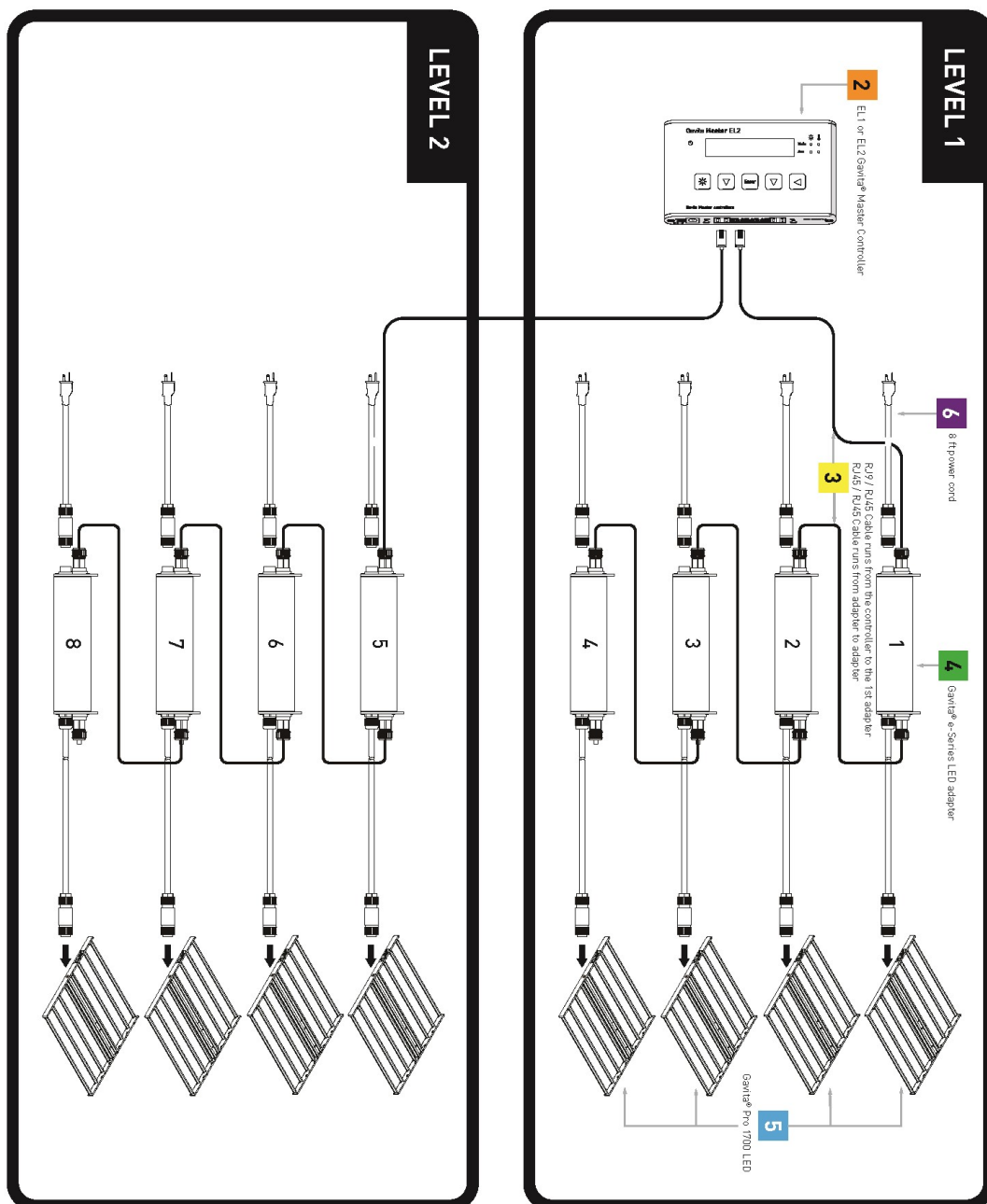



Spacesaver Corporation
1450 Janesville Avenue
Fort Atkinson, WI 53538-2798
1-800-492-3434
www.spacesaver.com

Spacesaver Corporation is a subsidiary of KI
KI and Spacesaver are registered trademarks of Krueger International, Inc.



KI
1330 Bellevue Street
P.O. Box 8100
Green Bay, WI
54302-8100
1-800-424-2432
www.ki.com